

SERIJA A - lahka izvedba

DIN 3015₁

Pribor za pritrjevanje Lahka izvedba

Privarilna ploščica AP - A					Oznaka - Fe	Oznaka - INOX
Grupa	A1	B	C	S		
0	30	0	30	3	AP - A 0	AP - A 0 / V2A
1	36	20	30	3	AP - A 1	AP - A 1 / V2A
2	42	26	30	3	AP - A 2	AP - A 2 / V2A
3	50	33	30	3	AP - A 3	AP - A 3 / V2A
4	59	40	30	3	AP - A 4	AP - A 4 / V2A
5	72	52	30	3	AP - A 5	AP - A 5 / V2A
6	88	66	30	3	AP - A 6	AP - A 6 / V2A
7	122	93	30	5	AP - A 7	AP - A 7 / V2A
8	148	120	30	5	AP - A 8	AP - A 8 / V2A

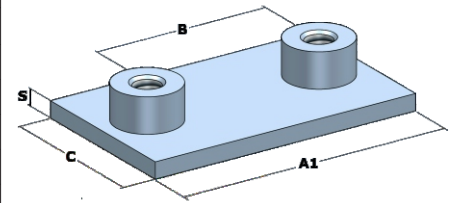

Ojačitvena ploščica DP - A					Oznaka - Zn	Oznaka - INOX
Grupa	A	B	C	S		
0	28	0	30	3	DP - A 0	DP - A 0 / V2A
1	34	20	30	3	DP - A 1	DP - A 1 / V2A
2	40	26	30	3	DP - A 2	DP - A 2 / V2A
3	48	33	30	3	DP - A 3	DP - A 3 / V2A
4	57	40	30	3	DP - A 4	DP - A 4 / V2A
5	70	52	30	3	DP - A 5	DP - A 5 / V2A
6	86	66	30	3	DP - A 6	DP - A 6 / V2A
7	118	93	30	3	DP - A 7	DP - A 7 / V2A
8	144	120	30	3	DP - A 8	DP - A 8 / V2A

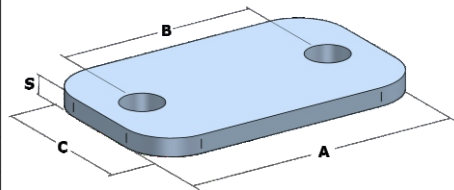

Vijak z šestrobo glavo **AS - A** (za montažo z ojačitveno ploščic - DP) DIN - 931

Grupa	Dimenzija d x L	Oznaka - Zn	Oznaka - INOX
0	M 6 x 30	AS - A 0	AS - A 0 / V2A
1	M 6 x 30	AS - A 1	AS - A 1 / V2A
2	M 6 x 35	AS - A 2	AS - A 2 / V2A
3	M 6 x 40	AS - A 3	AS - A 3 / V2A
4	M 6 x 45	AS - A 4	AS - A 4 / V2A
5	M 6 x 60	AS - A 5	AS - A 5 / V2A
6	M 6 x 70	AS - A 6	AS - A 6 / V2A
7	M 8 x 100	AS - A 7	AS - A 7 / V2A
8	M 8 x 130	AS - A 8	AS - A 8 / V2A

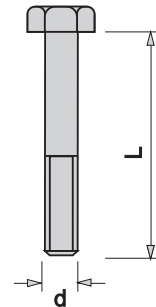

Vijak imbus **ISI - A** (za montažo brez ojačitvene ploščice - DP) DIN - 912

Grupa	Dimenzija d x L	Oznaka - Zn	Oznaka - INOX
0	M 6 x 20	ISI - A 0	ISI - A 0 / V2A
1	M 6 x 20	ISI - A 1	ISI - A 1 / V2A
2	M 6 x 25	ISI - A 2	ISI - A 2 / V2A
3	M 6 x 30	ISI - A 3	ISI - A 3 / V2A
4	M 6 x 35	ISI - A 4	ISI - A 4 / V2A
5	M 6 x 50	ISI - A 5	ISI - A 5 / V2A
6	M 6 x 60	ISI - A 6	ISI - A 6 / V2A
7	M 8 x 85	ISI - A 7	ISI - A 7 / V2A
8	M 8 x 115	ISI - A 8	ISI - A 8 / V2A

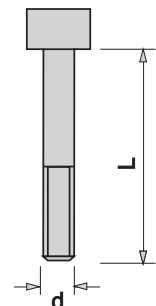

Vijak nadgradnja **AF - A**

Grupa	Dimenzija d x L	Oznaka - Zn	Oznaka - INOX
0	M 6 x 20	AF - A 0	AF - A 0 / V2A
1	M 6 x 20	AF - A 1	AF - A 1 / V2A
2	M 6 x 25	AF - A 2	AF - A 2 / V2A
3	M 6 x 30	AF - A 3	AF - A 3 / V2A
4	M 6 x 35	AF - A 4	AF - A 4 / V2A
5	M 6 x 50	AF - A 5	AF - A 5 / V2A
6	M 6 x 60	AF - A 6	AF - A 6 / V2A
7	M 8 x 85	AF - A 7	AF - A 7 / V2A
8	M 8 x 115	AF - A 8	AF - A 8 / V2A

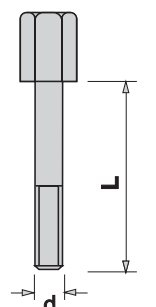

MATERIAL	
Fe	Surovo - črn
Zn	Pocinkan
Inox	Možnosti
V2A	1.4401 (AISI 316)
V4A	1.4301 (AISI 304)